

ST

Stainless Steel Submersible Pumps



台灣鯊威



60 Hz



ST

浮動式深井泵

STAINLESS STEEL
SUBMERSIBLE PUMPS



ST

Series 浮動式深井泵

特點及使用範圍

鯊威ST系列葉輪採用塑膠鋼(PPO)，泵軸(Hex)加強陶磁軸套，結構非常堅固，在抗沙上具有優異的表現，浮動式葉輪設計，降低起動轉矩的要求，不易因微量細沙卡死，增長馬達使用壽命，內置逆止閥及濾網，結構緊湊，安裝十分容易。獨特葉輪設計高效節能，更為您節省運行的費用、確保長期可靠免維護運行。

BASIC FEATURES

ST Series steel with plastic impeller (PPO), shaft (Hex) to strengthen ceramic sleeve, the structure is very strong, with excellent performance in the anti-sand, Floating impeller design, reduce starting torque requirements, increase the service life of the motor, the built-in check valve and strainer compact structure, installation is very easy. Energy efficient unique impeller design, saving more on running costs and ensure reliable long-term maintenance-free operation.

Technical Specifications:

技術規格

Feature

- The discharge has a built-in check valve
- The pump body is covered by a 304 polished stainless steel shell
- The shaft are made from hex 304 stainless steel bar material
- Impellers are floating type (Noryl)
- umped Liquids:
 - Clean, non-corrosive and non-abrasive liquids
- Operating Conditions:
 - Max. Liquids temperature : 60°C
 - Sand content: Max. 50g/m3

特點

- 內建逆止閥
- 適用於清水
- 最高使用環境水溫60°C
- 最大含沙量 50g/m3

應用

- 飲用水供應，從深水井
- 農業，灌溉，牲畜飲水
- 市政和工業增壓
- 噴泉等

Pump Type Key

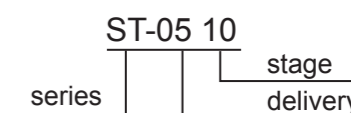

Application

- Water supply
- Irrigation
- Municipal and industrial
- Pressure boosting
- Fountains, etc

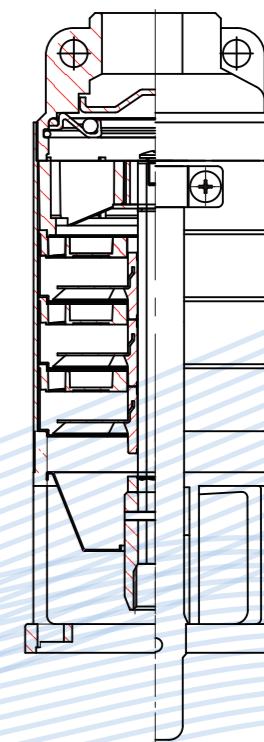

4" ST-05

PERFORMANCE CURVES

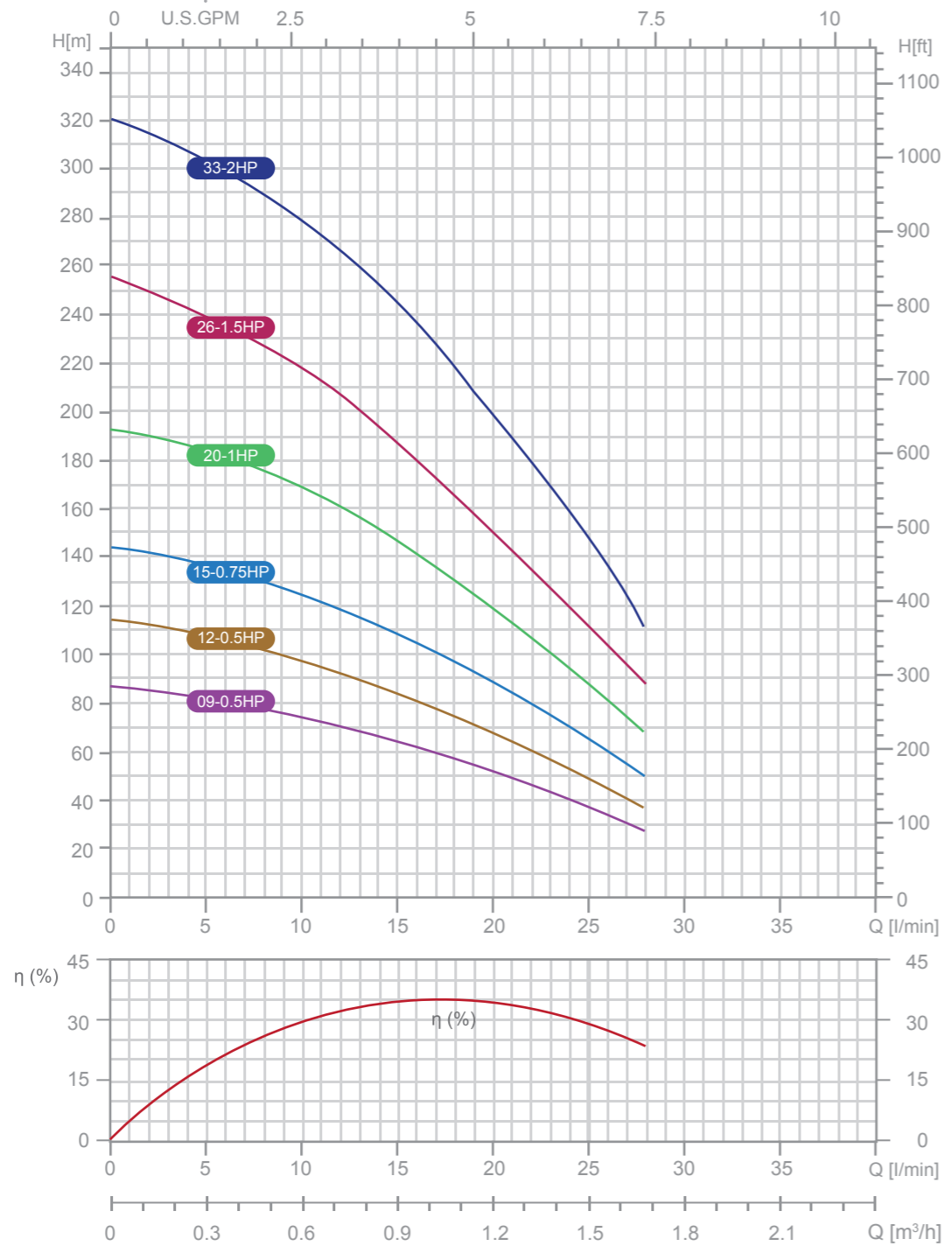
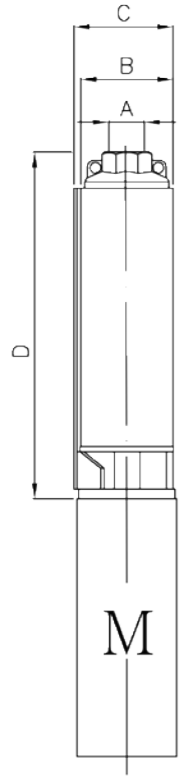

PUMP TYPE	Dimensions (mm)				Weight (kg)	Motor		Q=DELIVERY					
								L/min	10	15	20	25	30
	A	B	C	D		M³/hr	0.6	0.9	1.2	1.5	1.8	2.1	
ST-0509	1 1/4"	87.3	98	306	3.1	0.37	0.5	87	75	65	52	38	21
ST-0512				359	3.6	0.37	0.5	114	98	85	68	49	28
ST-0515				411	4.1	0.55	0.75	144	124	110	89	65	39
ST-0520				499	4.9	0.75	1	193	169	148	120	88	53
ST-0526				642	5.8	1.1	1.5	255	219	179	152	112	68
ST-0533				757	7.3	1.5	2	320	280	245	200	145	82

4" ST-10

PERFORMANCE CURVES

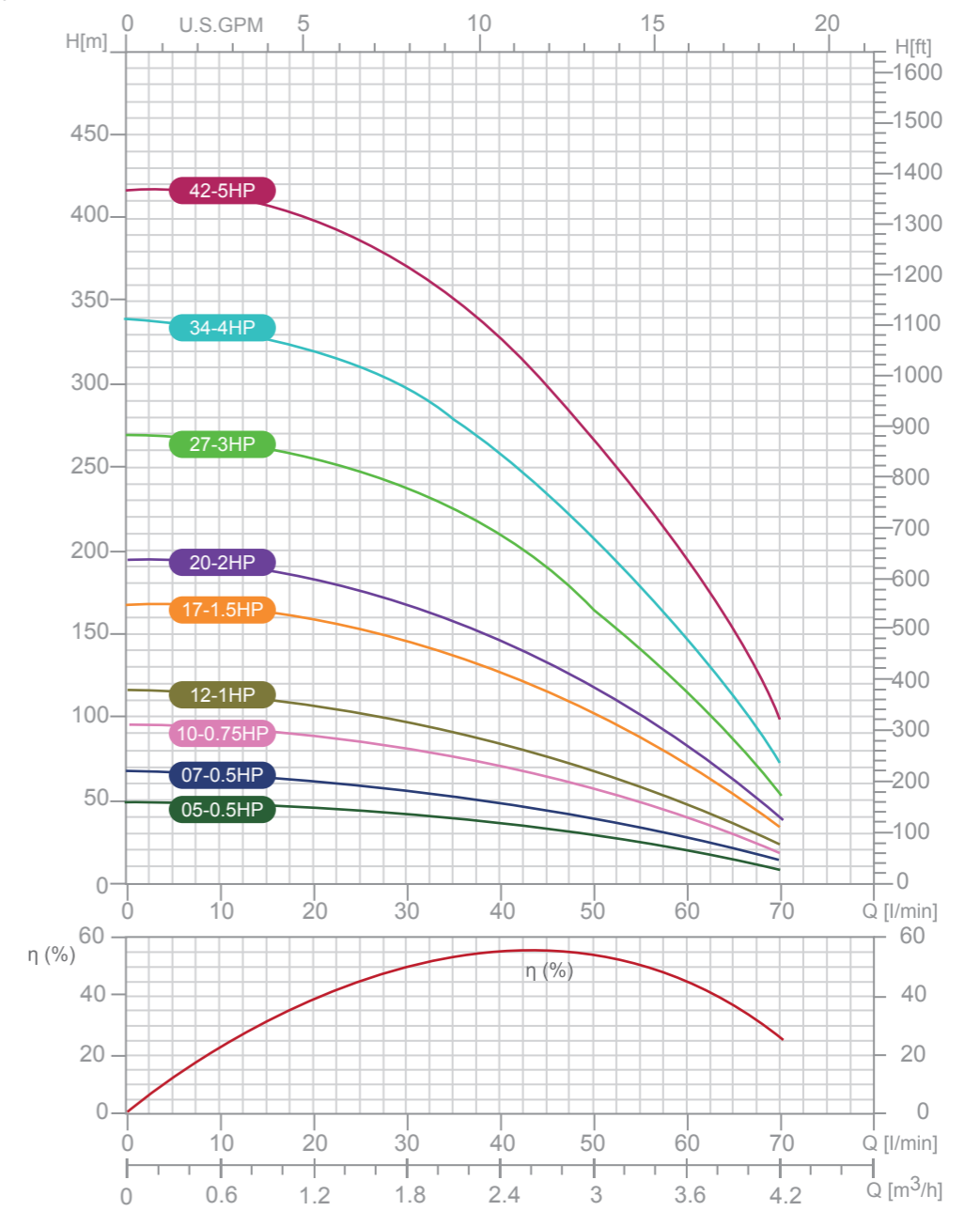
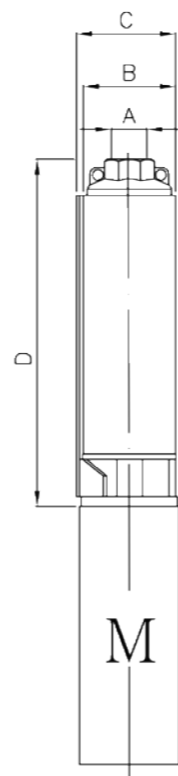

PUMP TYPE	Dimensions (mm)				Weight (kg)	Motor		Q=DELIVERY											
								L/min	15	20	25	30	35	40	50	60	70	80	
	A	B	C	D		M³/hr	0.9	1.2	1.5	1.8	2.1	2.4	3	3.6	4.2	4.8			
ST-1005	1 1/4"	87.3	98	236	2.5	0.37	0.5	48	44	42	40	38	36	29	19	9			
ST-1007				271	2.8	0.37	0.5	67	60	58	55	52	49	39	27	13			
ST-1010				324	3.3	0.55	0.75	96	89	85	81	77	71	58	40	19			
ST-1012				359	3.6	0.75	1	115	106	102	98	92	85	68	47	23			
ST-1017				447	4.4	1.1	1.5	168	159	152	147	138	128	102	70	35			
ST-1020				499	4.9	1.5	2	195	181	177	168	158	146	118	82	40			
ST-1027				660	6.0	2.2	3	270	255	247	237	223	209	167	111	53			
ST-1034				758	7.5	3	4	339	320	310	296	280	259	209	146	70			
ST-1042				916	8.8	3.7	5	412	389	375	358	338	315	258	186	95			

4" ST-25

PERFORMANCE CURVES

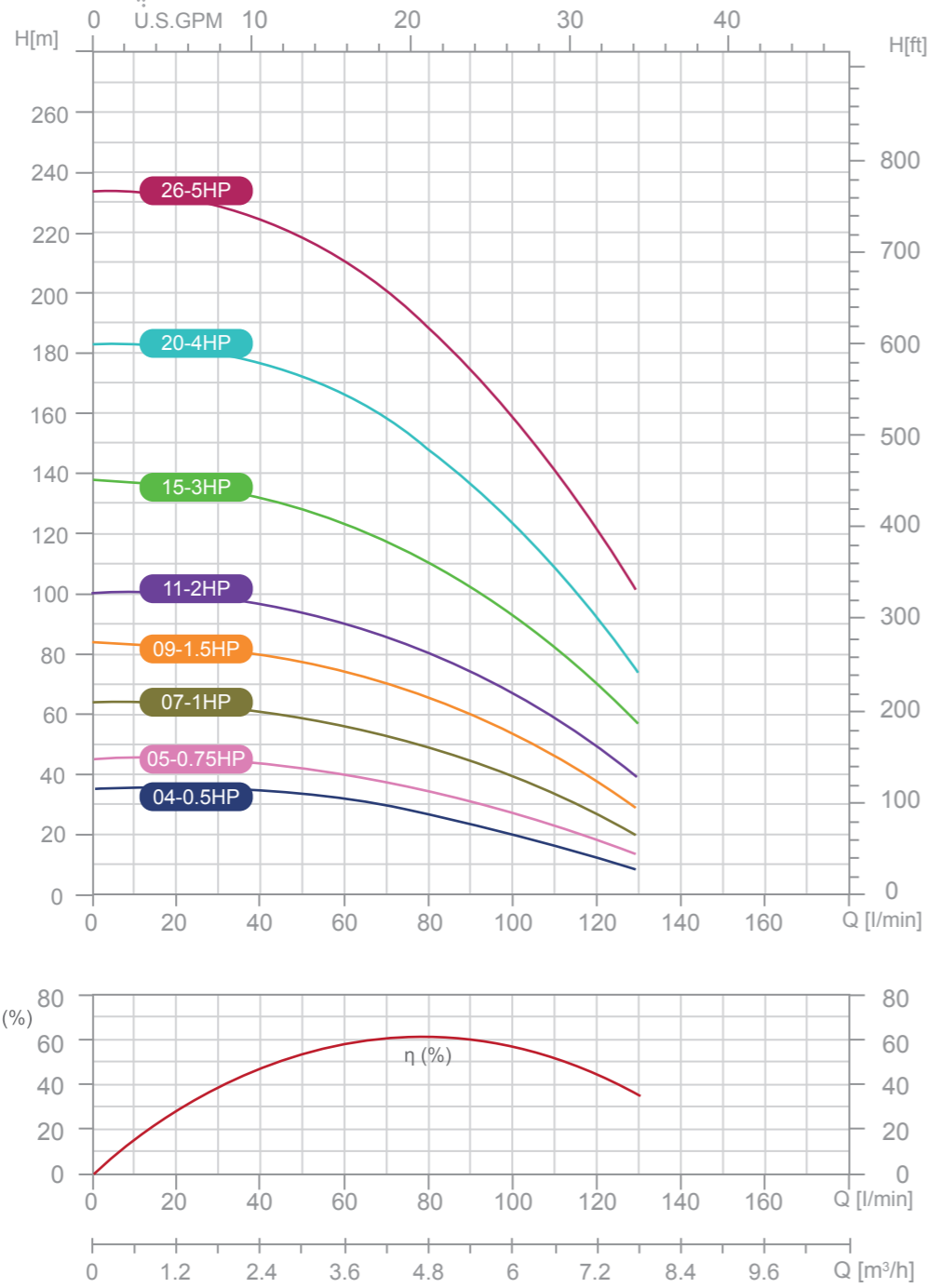
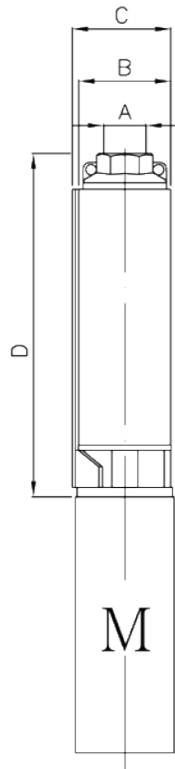

PUMP TYPE	Dimensions (mm)				Weight (kg)	Motor		Q=DELIVERY											
								H=TOTAL HEAD IN METER											
	A	B	C	D		L/min 0	40	50	60	70	80	90	100	120	140				
ST-2504	1 1/2"	87.3	98	247	2.4	0.37	0.5	36		33	31	29	27	23	20	12			
ST-2505				272	2.6	0.55	0.75	46		42	40	38	35	32	28	19			
ST-2507				320	3.1	0.75	1	63		58	55	52	48	43	37	25			
ST-2509				370	3.5	1.1	1.5	82		76	73	69	64	58	52	35			
ST-2511				419	3.9	1.5	2	100		92	86	84	78	71	64	45			
ST-2515				518	4.7	2.2	3	136		125	121	115	107	100	90	69			
ST-2520				679	5.8	3	4	183		172	168	158	148	137	122	92			
ST-2526				864	7.1	3.7	5	234		214	206	196	183	169	152	112			

4" ST-35

PERFORMANCE CURVES

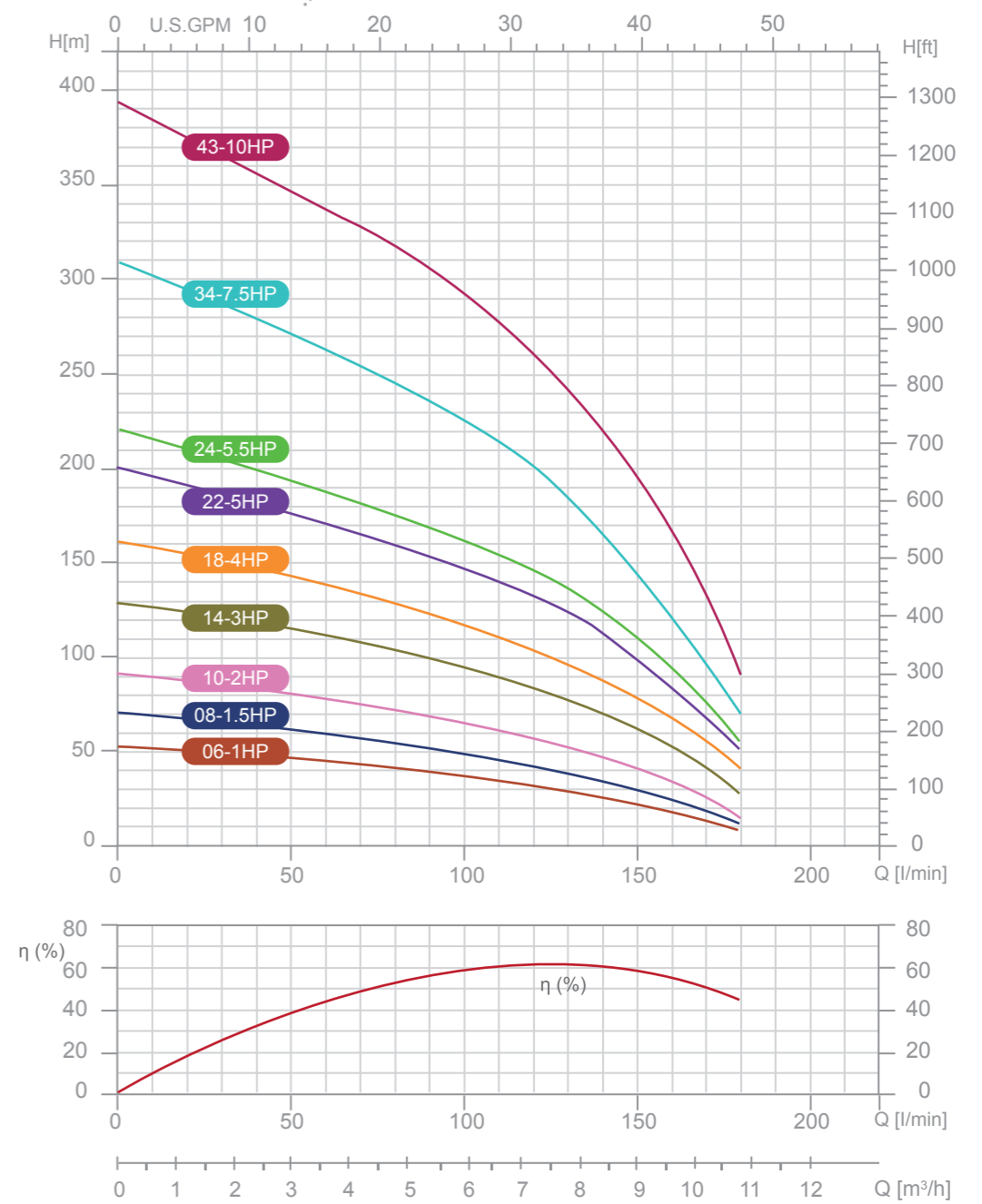
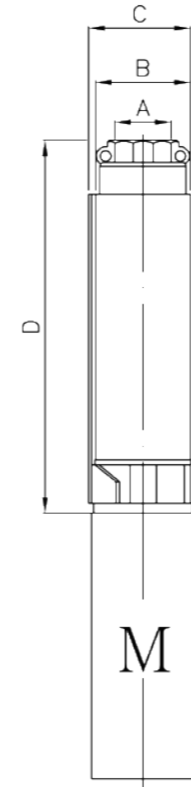

PUMP TYPE	Dimensions (mm)				Weight (kg)	Motor		Q=DELIVERY											
								H=TOTAL HEAD IN METER											
	A	B	C	D		L/min 0	50	60	70	80	90	100	120	140	160	180	200		
ST-3506	2"	87.3	98	359	3.4	0.75	1	52		44	43	42	40	38	33	27	18	9	
ST-3508				421	4	1.1	1.5	70		60	58	55	52	50	43	35	24	12	
ST-3510				483	4.6	1.5	2	91		77	75	72	69	65	58	48	32	17	
ST-3514				607	5.7	2.2	3	128		109	106	102	99	94	83	70	51	29	
ST-3518				731	6.9	3	4	160		139	133	129	123	117	104	89	67	40	
ST-3522				893	8.1	3.7	5	200		170	165	159	152	147	132	111	84	50	
ST-3524				955	8.7	4	5.5	220		189	182	177	170	162	148	125	95	55	
ST-3534				1257	11.6	5.5	7.5	308		263	255	246	236	225	200	167	122	69	
ST-3543				1318	14.2	7.5	10	394		339	328	317	305	292	261	220	167	90	

4" ST-40

PERFORMANCE CURVES

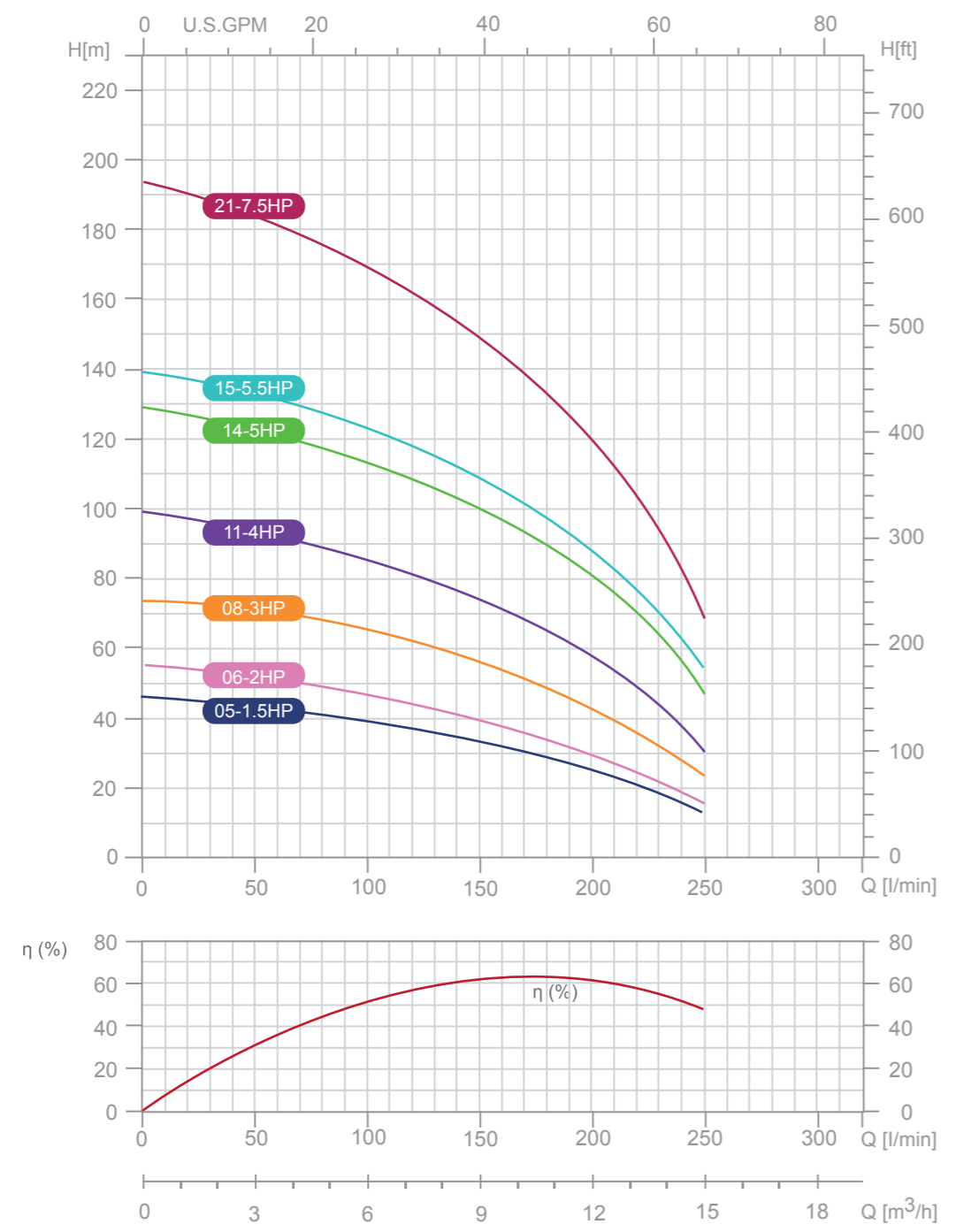
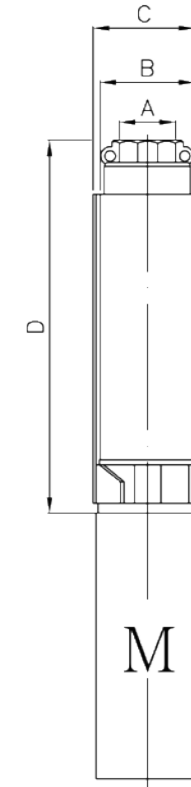

PUMP TYPE	Dimensions (mm)				Weight (kg)	Motor			Q=DELIVERY															
									H=TOTAL HEAD IN METER															
	A	B	C	D		L/min 0	60	70	80	90	100	120	140	160	180	200	250	280						
ST-4005	2"	87.3	98	325	3.1	1.1	1.5	46	42	41	40	39	37	35	33	29	25	14						
ST-4006				356	3.4	1.5	2	55	49	48	47	47	45	42	38	35	30	17						
ST-4008				418	4	2.2	3	74	69	68	67	66	63	60	56	50	43	24						
ST-4011				511	4.9	3	4	100	91	88	87	86	83	78	73	66	58	30						
ST-4014				604	5.7	3.7	5	129	118	116	115	113	108	103	97	90	81	48						
ST-4015				638	6	4	5.5	139	128	126	125	123	118	113	105	97	88	55						
ST-4021				859	7.8	5.5	7.5	194	178	175	173	169	162	154	145	134	120	68						

4" ST-55

PERFORMANCE CURVES

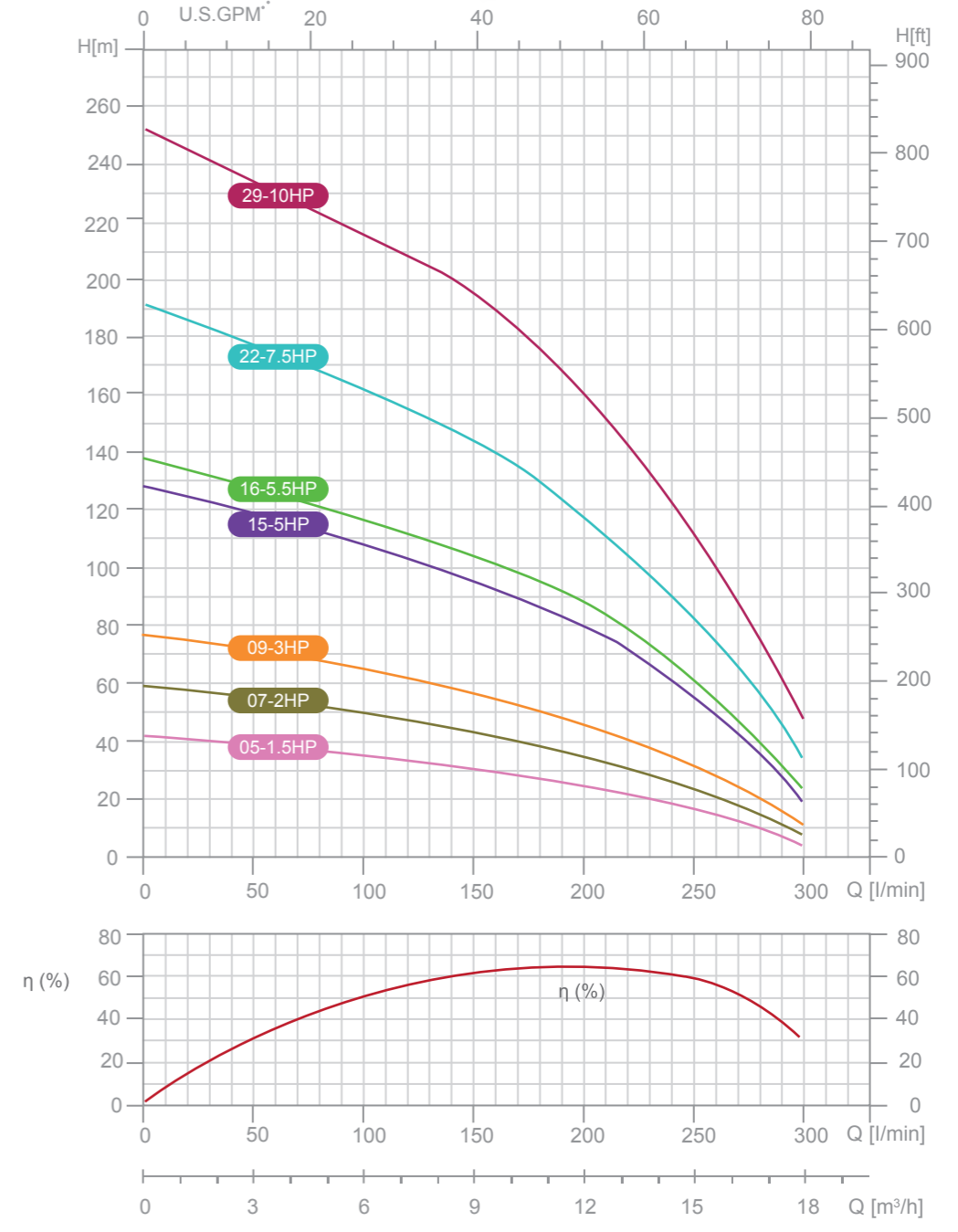
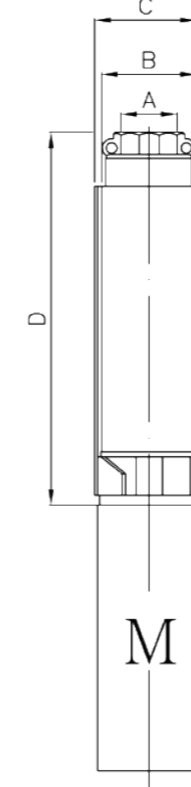

PUMP TYPE	Dimensions (mm)				Weight (kg)	Motor			Q=DELIVERY															
									H=TOTAL HEAD IN METER															
	A	B	C	D		L/min 0	70	80	90	100	120	140	160	180	200	220	240	260	280	300	340			
ST-5505	2"	87.3	98	433	4.3	1.1	1.5	42	38	37	36	34	32	30	28	25	22	18	14	9	5			
ST-5507				537	5.3	1.5	2	59	52	51	50	48	46	43	40	36	31	26	21	15	8			
ST-5509				641	6.2	2	3	75	67	66	64	62	59	56	52	47	42	35	28	19	11			
ST-5515				953	9	3.7	5	128	113	112	109	105	100	94	88	80	72	63	51	37	20			
ST-5516				1005	9.5	4	5.5	137	122	120	117	112	107	101	95	88	79	68	55	40	23			
ST-5522				1345	12.3	5.5	7.5	191	169	166	162	156	149	140	131	118	106	91	75	55	35			
ST-5529				1708	15.6	7.5	10	251	225	221	218	209	200	190	177	161	144	125	101	75	48			

4" ST-60

PERFORMANCE CURVES

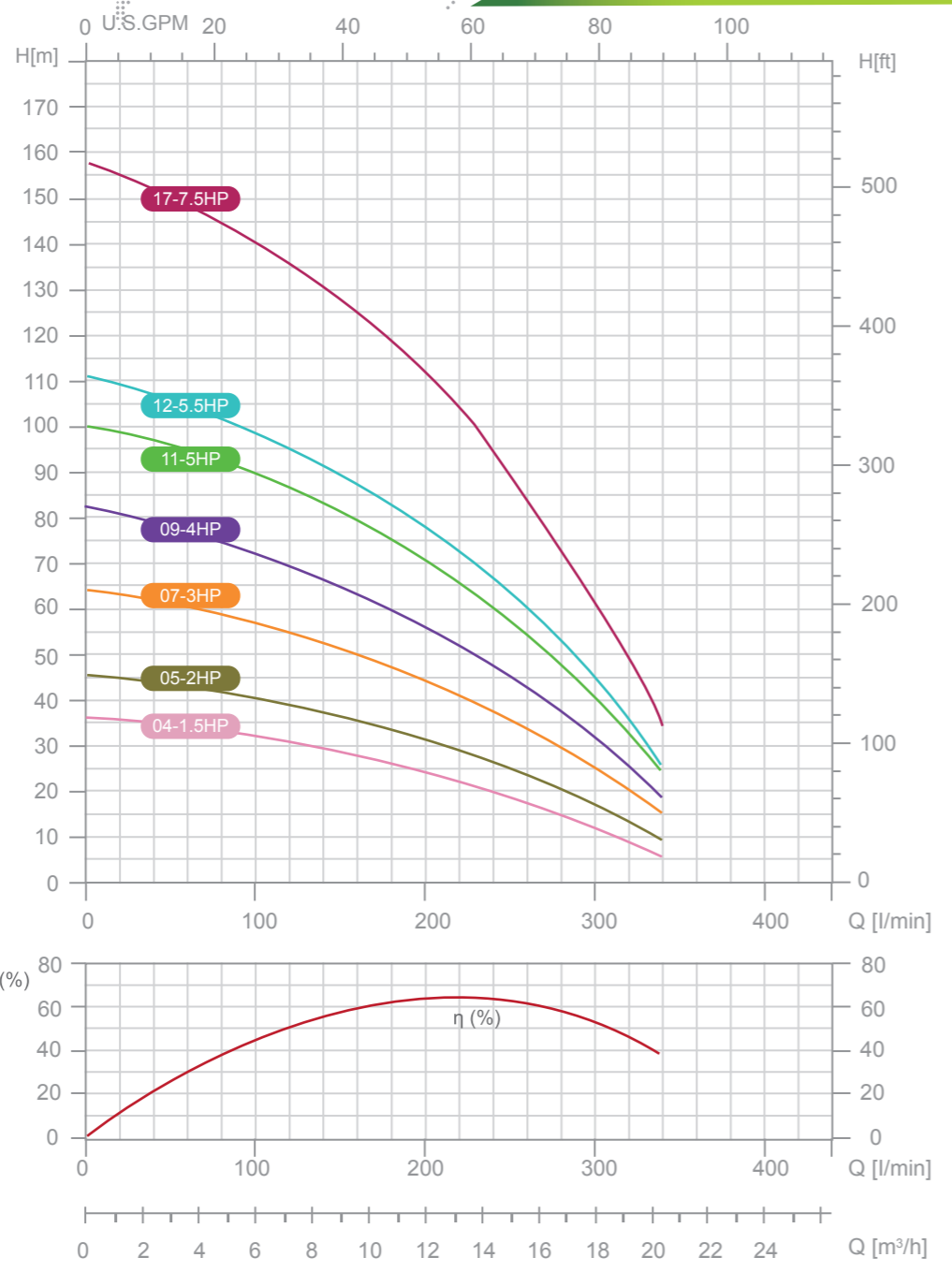
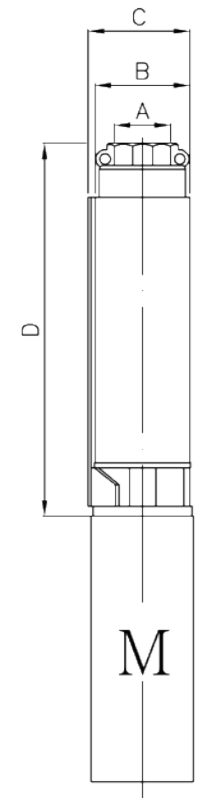

PUMP TYPE	Dimensions (mm)				Weight (kg)	Motor		Q=DELIVERY																
								H=TOTAL HEAD IN METER																
	A	B	C	D		L/min	90	100	120	140	160	180	200	220	240	260	280	300	340	380				
ST-6004	2"	87.3	98	378	3.9	1.1	1.5	36	32	31	30	28	26	24	22	19	17	14	12	6				
ST-6005				430	4.4	1.5	2	46	41	39	37	36	34	32	29	26	23	20	17	9				
ST-6007				534	5.3	2.2	3	54	57	55	53	51	48	45	42	38	34	30	25	15				
ST-6009				638	6.3	3	4	82	72	69	67	64	60	56	52	47	42	37	32	18				
ST-6011				742	7.2	3.7	5	109	90	87	83	80	75	71	67	60	54	48	41	24				
ST-6012				797	7.7	4	5.5	110	98	95	92	88	84	78	73	67	60	55	44	26				
ST-6017	1092	10.1	5.5	7.5	157	140	136	131	126	119	112	104	95	85	73	61	35							

4" ST-80

PERFORMANCE CURVES

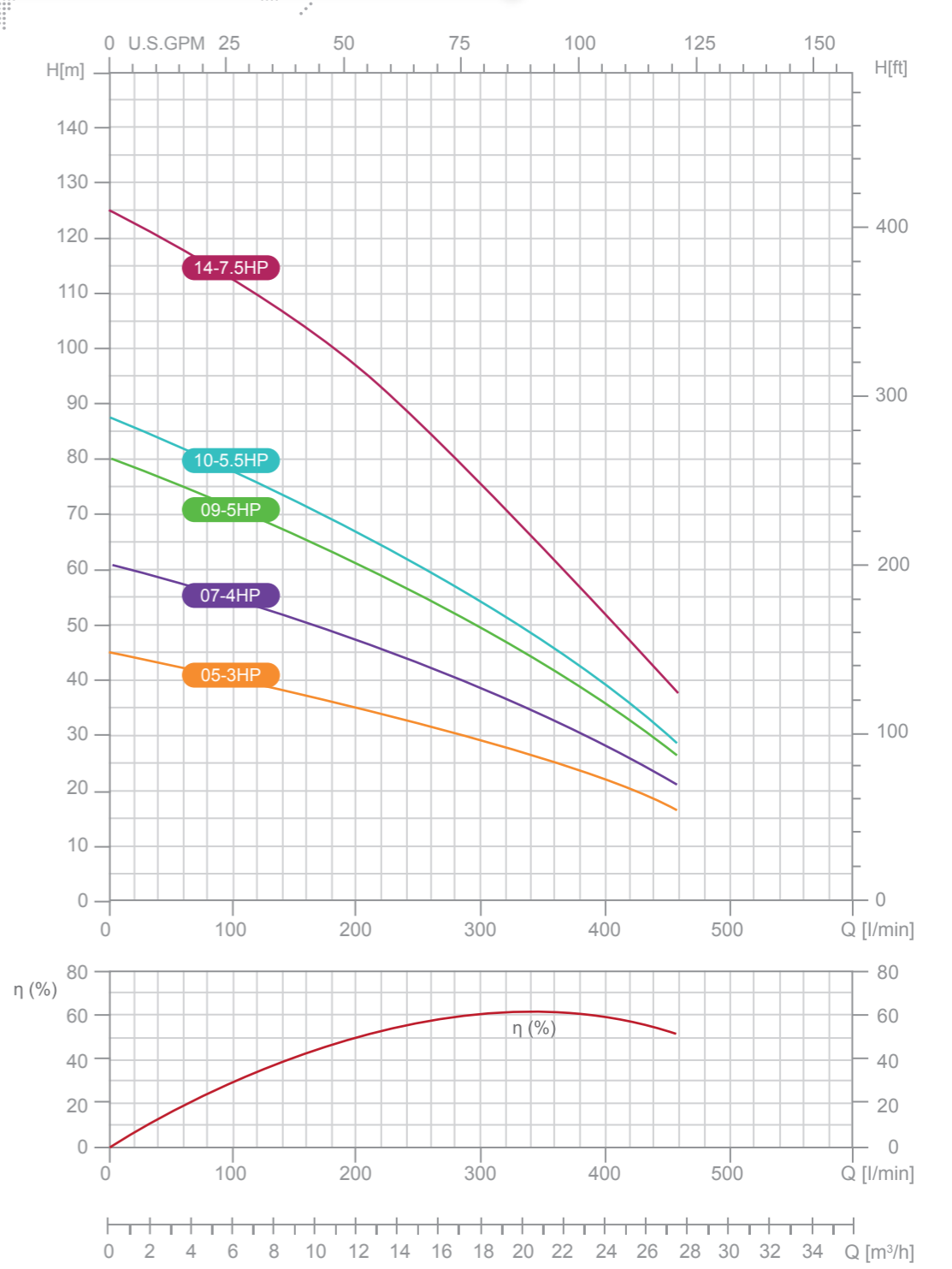
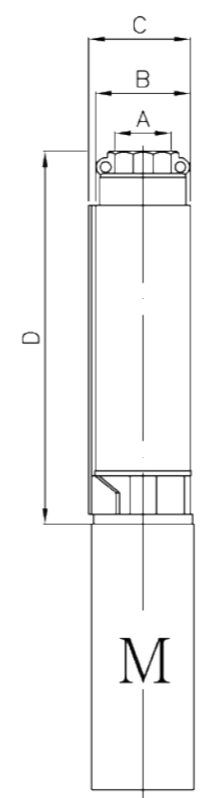

PUMP TYPE	Dimensions (mm)				Weight (kg)	Motor		Q=DELIVERY																
								H=TOTAL HEAD IN METER																
	A	B	C	D		L/min	140	160	180	200	220	240	260	280	300	340	380	420	460	500				
ST-8005	2"	87.3	98	472	4.4	2.2	3	44	36	34	33	32	30	29	28	26	23	19	14	10				
ST-8007				608	5.6	3	4	61	50	49	47	45	43	41	40	38	33	28	23	18				
ST-8009				743	6.9	3.7	5	80	65	63	61	58	56	54	51	49	43	36	30	23				
ST-8010				814	7.5	4	5.5	88	73	70	68	65	63	60	57	54	48	41	34	27				
ST-8014				1081	9.9	5.5	7.5	126	104	101	97	93	89	85	80	76	57	48	38					